

KBS LTER Resource Gradient Experiment Location/History*

(Previously known as the Nitrogen Rate Study and Nitrogen Fertility Gradient)

LTER Main Site

1999

An unreplicated demonstration study (A)

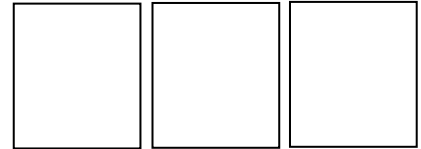

2000-2001

Rainfed corn N-treatments established on west side (B).

Soy grown on east side (C), but not part of the experiment.



2002

Rainfed corn N-treatments continue on west side (B).

Irrigated Corn N-treatments established on east side (C), but not irrigated. Data collected from both sides.

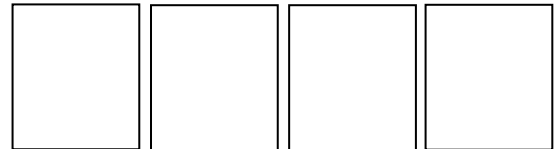

2003-2004

Rainfed corn N-treatments continue on west side (B).

Irrigation begins on Irrigated corn N-treatments on east side (C).



2005

Rainfed and Irrigated corn N-treatments moved to new location (D).

Rainfed data also collected from original site (B).

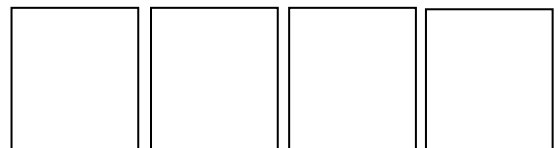

2006-present

Rainfed and Irrigated N-treatments follow crop rotation of the LTER Main Cropping System Experiment (D).

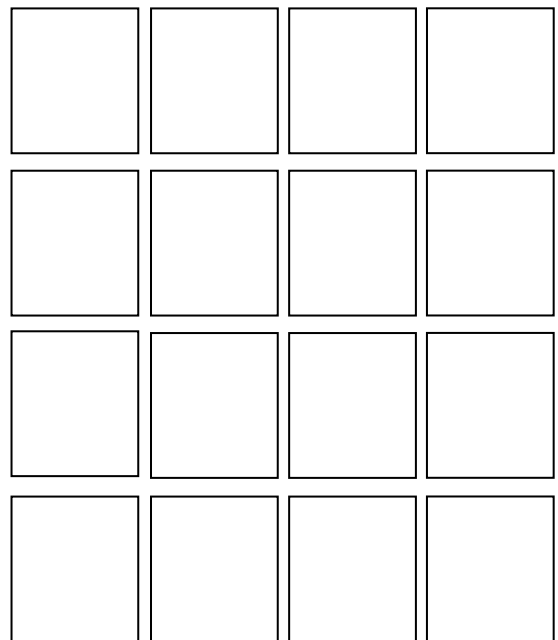
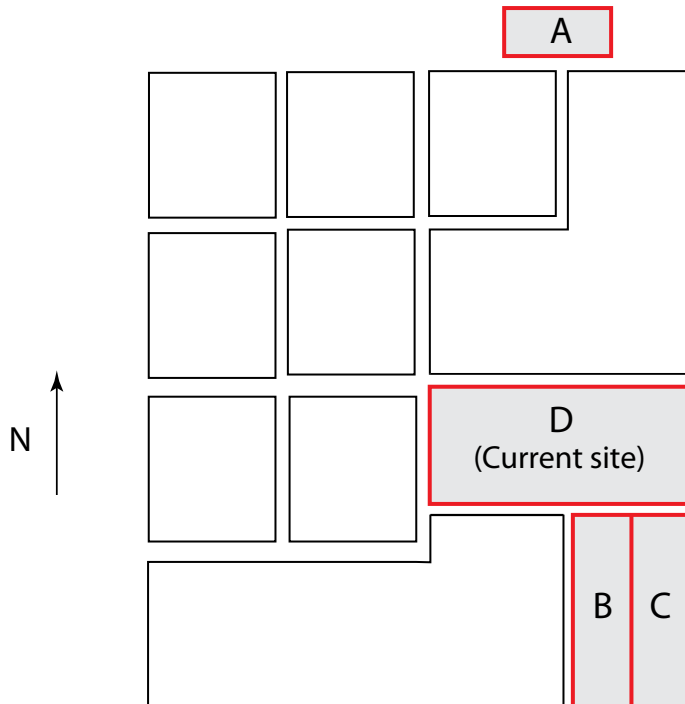

*Based on air photo analysis, Project Log, Ag Log, and McSwiney et al. (2005; Global Change Biology 11: 1712-1719).